

Double ended shear beam load cell



Features

Capacity 1t-30t

High accuracy

High stability

Nickel plated alloy steel

Optional features

Stainless steel construction

DESCRIPTION

The ZMQS is double ended shear beam load cell, capacity from 1t up to 30t. The load cell is widely used in evelator. We provide optional amplifier which converts analog sigal into 4-20mA, 0-5V or 0-10V.

DIMENSIONS (mm)

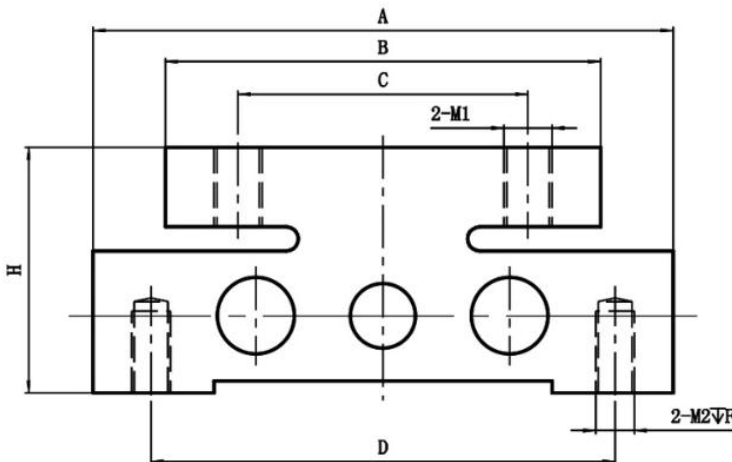

量程	A	B	C	D	E	H	M1	M2	F
1-5t	220	140	110	186	45	85	M16	M12	20
10-20t	240	180	120	192	50	93	M20	M16	30
30t	240	180	120	192	56	102	M20	M16	30

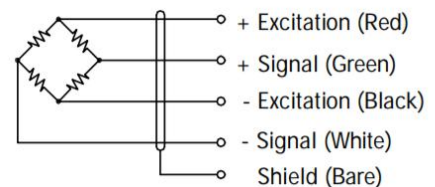
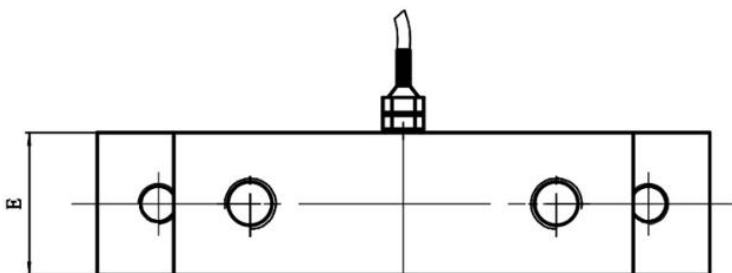

SPECIFICATIONS

PARAMETER	VALUE	UNIT
Standard capacities (E _{max})	1-30	T
Rated output-R.O.	2.0	mV/V
Zero balance	1	±% of rated output
Non linearity	0.1	±% of rated output
Hysteresis	0.1	±% of rated output
Non-repeatability	0.05	±% of rated output
Creep error (30 minutes)	0.03	±% of rated output
Zero return (30 minutes)	0.03	±% of rated output
Temperature effect on min. dead load output	0.0026	±% of rated output/°C
Temperature effect on sensitivity	0.0015	±% of rated output/°C
Compensated temperature range	-10 to +40	°C
Operating temperature range	-20 to +60	°C
Safe overload	150	% of R.C
Ultimate overload	200	% of R.C
Excitation, recommended	10	Vdc
Excitation, maximum	15	Vdc
Input resistance	360±10	Ohms
Output resistance	350±3	Ohms
Insulation resistance	5000	Mega-Ohms
Material	Alloy steel	
Protection class	IP66	

All specifications listed subject to change without notice.